



To learn about other Suncast products, please call
1-855-477-1260 or 1-630-879-2050.



Product Feedback? Go To: Suncastcommercial.com/feedback
OR email us at: feedback@suncastcommercial.com

ITEM NUMBER: CPD200PRO

Parts & Hardware

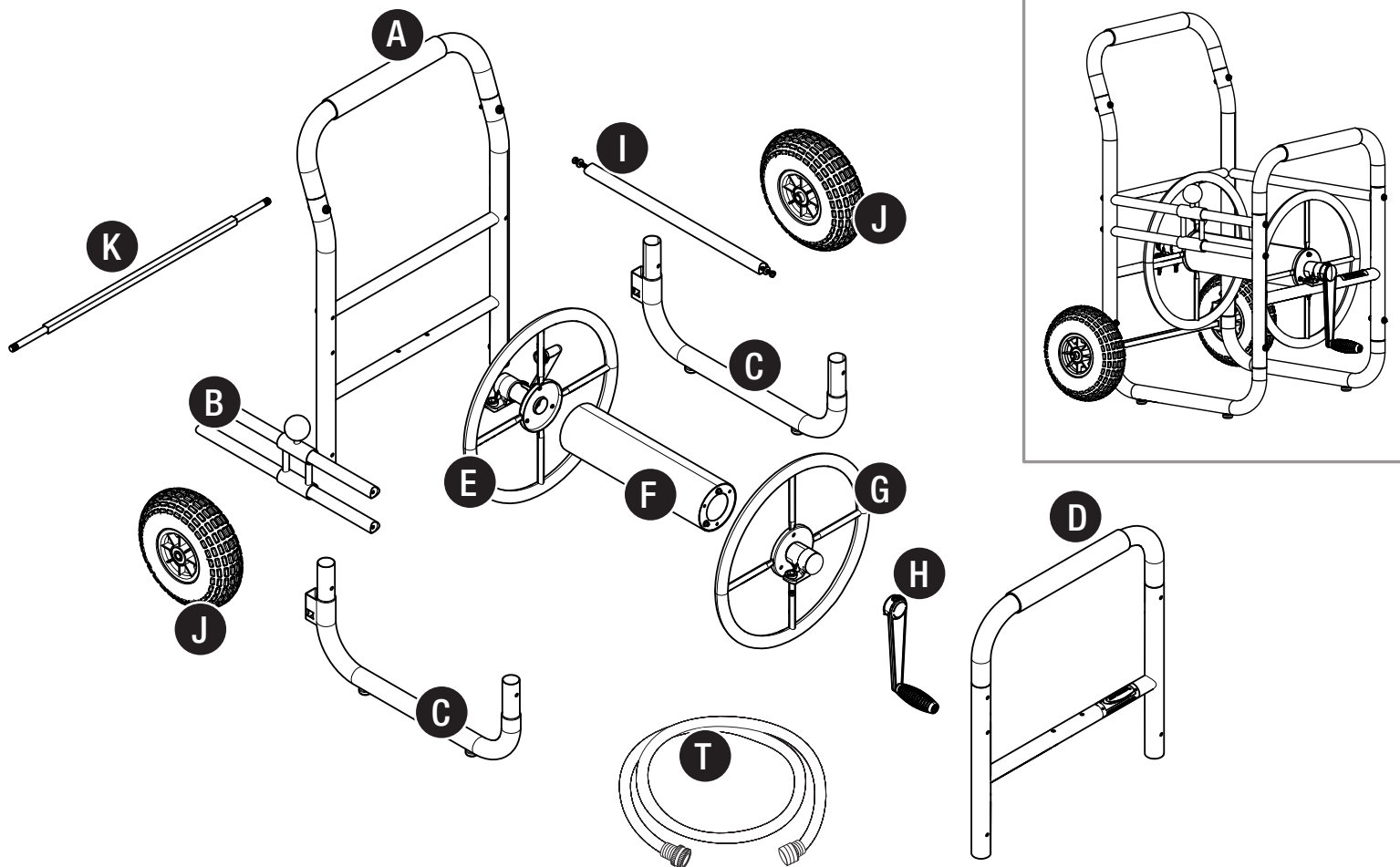

Parts	Description	Quantity
A	Rear Frame	1
B	Tracker Assembly	1
C	Bottom Tubes	2
D	Front Frame	1
E	Rear Flange	1
F	Drum	1
G	Front flange	1
H	Crank	1
I	Side Bar	1
J	Wheels	2
K	Axle	1
T	Leader Hose	1

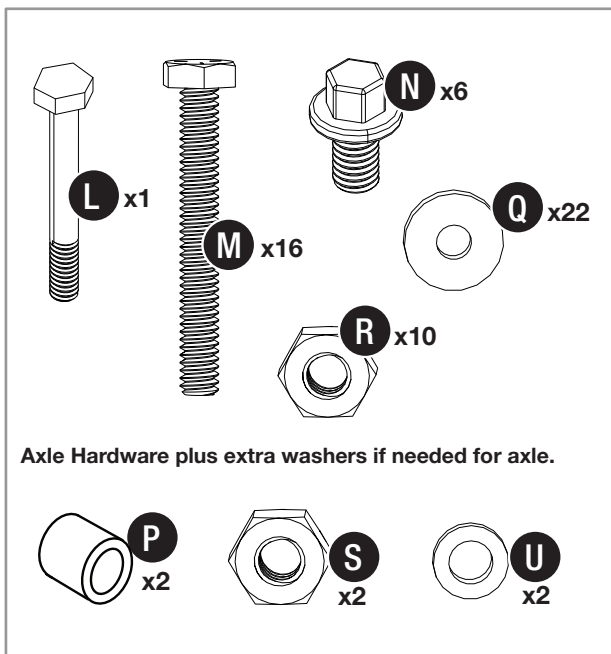

TOOLS NEEDED

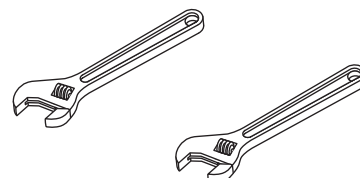



Before You Begin...

- **Read instructions thoroughly prior to assembly.**

This kit contains parts that can be damaged if assembled incorrectly or in the wrong sequence.

- **Please follow instructions.**

Suncast is not responsible for replacing parts lost or damaged due to incorrect assembly.

- **Check for all parts before you begin assembly.**

Using the provided parts check list, verify that you have all the parts required to assemble your hose reel.



Caution

- Not intended for use by children.
- This product may become susceptible to impact damage in freezing temperatures.
- **DO NOT** store near excessive heat.
- **DO NOT** sit or stand on hose reel.

Important Instructions

- To help prevent rust, check for any scratches on your hose cart. Apply clear acrylic/weatherproof paint to avoid rusting.
- When attaching the garden hose to the out-tube and/or the leader hose to the in-tube, be sure to attach correctly. Cross threading could cause permanent damage.
- Before winding your hose, remove the nozzle or other attachment and drain as much water out of the hose as possible. This will prevent extra stress on the hose reel (from the weight of the water) that could cause permanent damage.
- To unwind your hose, pull the hose out away from your hose reel in a straight line. To rewind the hose, walk the end back to the hose reel so the hose is in a "U" shape in front of the reel. This assists in easier rewinding of the hose. If applicable, place your foot ON the right side foot hold during winding and unwinding to stabilize the unit, and keep hands free from the range of the rotating crank handle.
- When you are finished using your hose reel, turn off the water source. Do not leave water pressure on when not in use.
- Store hose reel indoors during colder months. If hose reel must be left in freezing conditions, disconnect hose from faucet and drain all water out of hose and reel. Freezing of trapped water may cause damage to reel, hose or pipes.
- Check in-tube and out-tube connections prior to first use each spring. If hose reel starts to leak, tighten all water connections and check washers in the in-tube and the garden hose. Replace washers, if necessary.
- Once a year, remove the in-tube and clean and re-lube the o-rings. Re-install the in-tube.

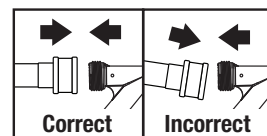

Pre Assembly

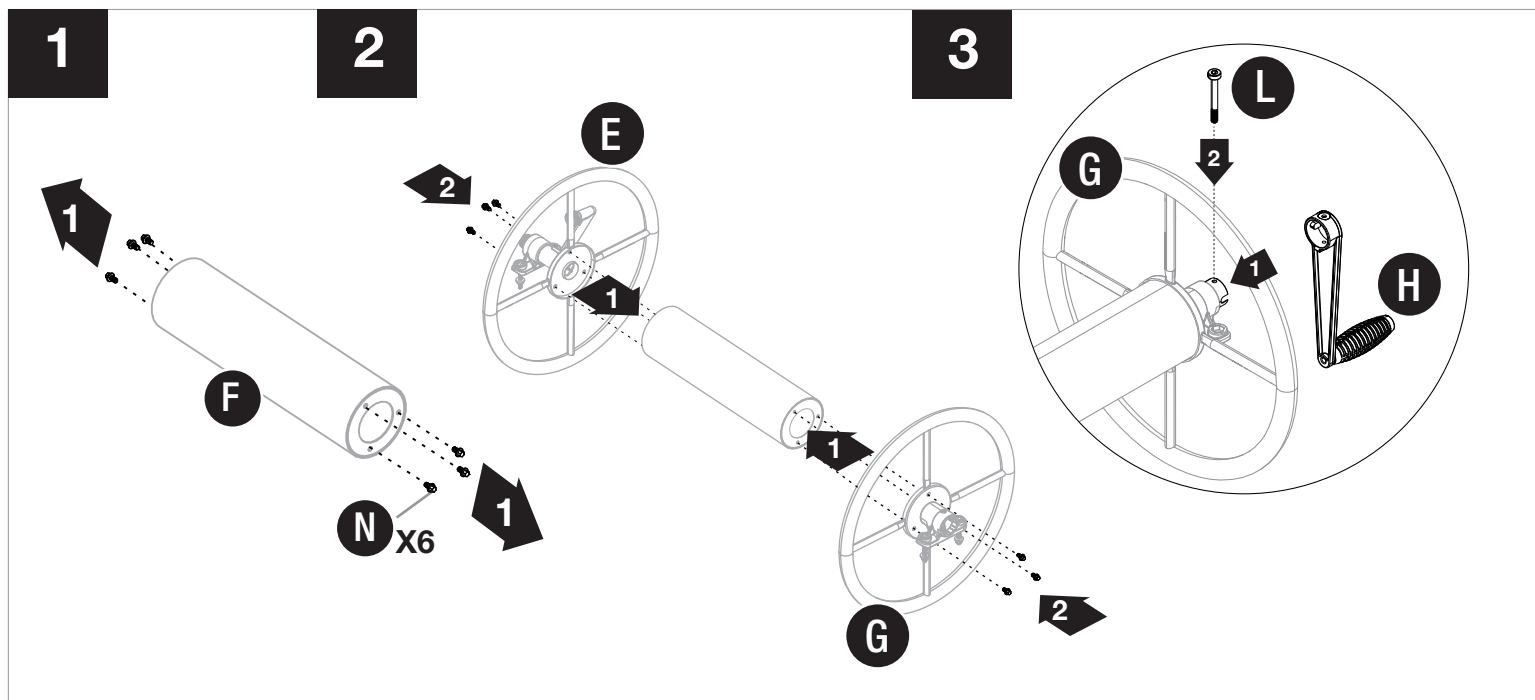

Remove hardware (N) from Drum (F). Attach flanges (E) and (G) to drum using six screws (N). Attach crank (H) to flange (G) using one bolt (L). Insert bolt (L) through clearance hole, then thread into welded nut.

Once assembled set aside. Reel assembly attaches to base in step 10.

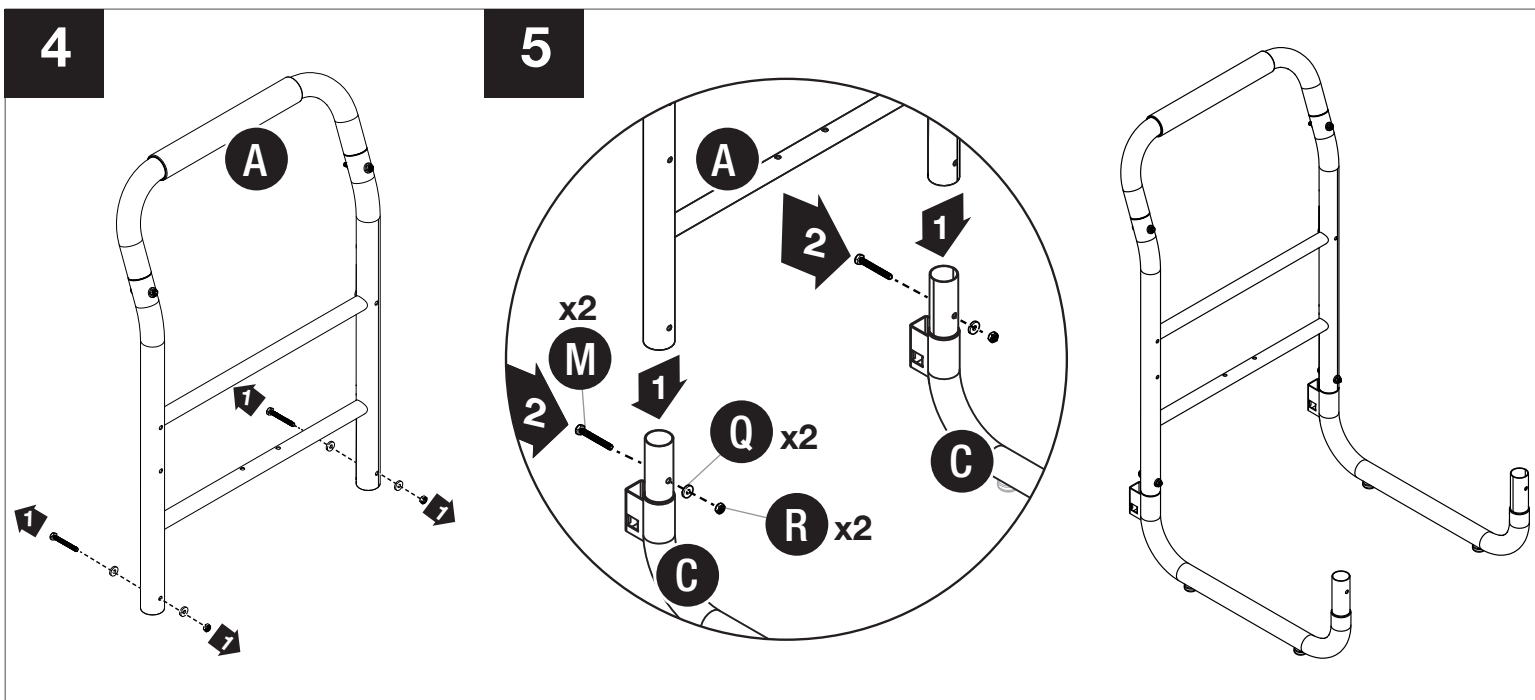

Remove hardware from Rear frame (A). Lower frame (A) into bottom tubes (C) and attach using two bolts (M), two washers (Q) and two nuts (R). (Step 5 uses the same hardware as previously taken out in step 4).

CAUTION: Handle frame should be attached as shown in step 5.

6

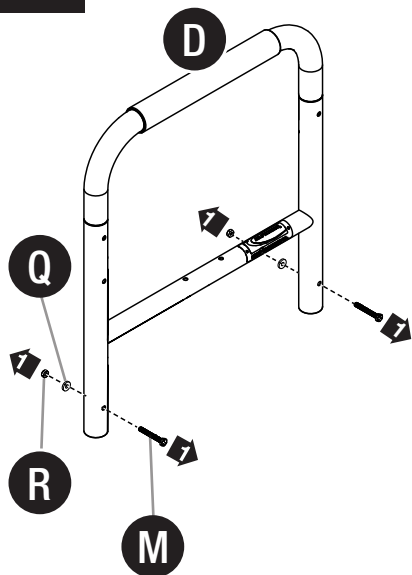

7

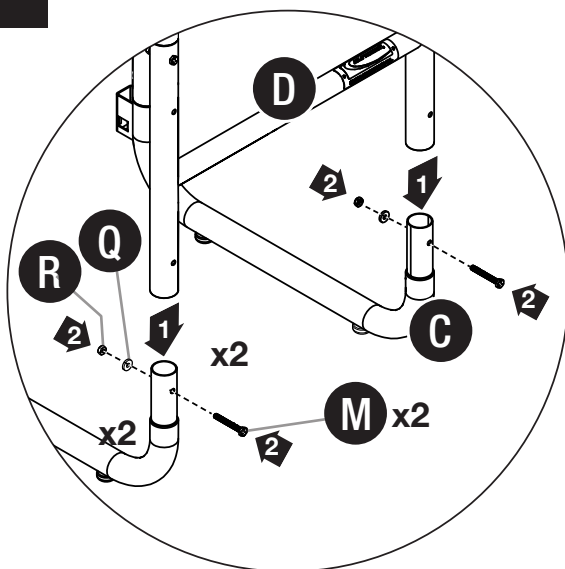

8

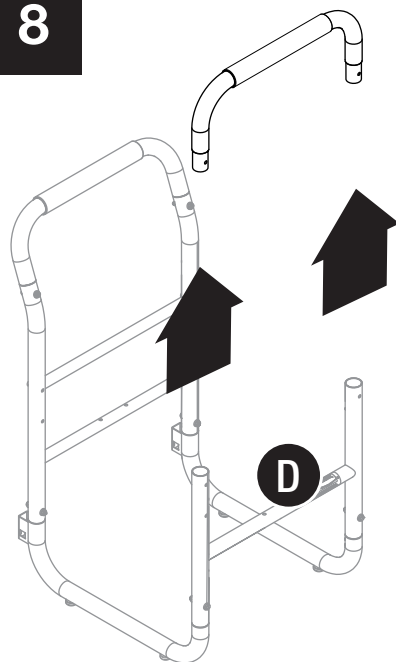

Remove hardware from Front frame (D). Insert Front Frame (D) into bottom tubes (C). Attach using 2 bolts (M), 2 washers (Q) and 2 nuts (R). Temporarily remove Front Handle of (D). Set aside until step 11.

9

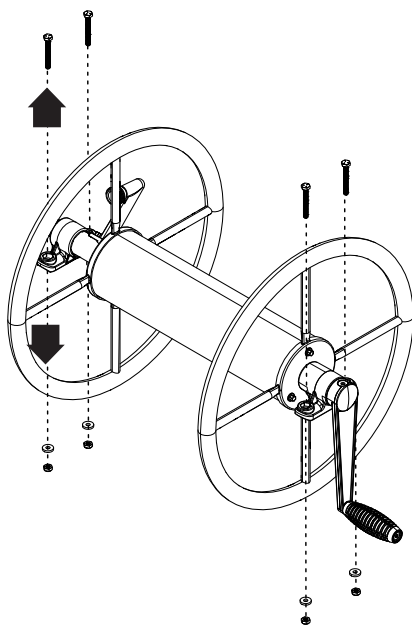

10

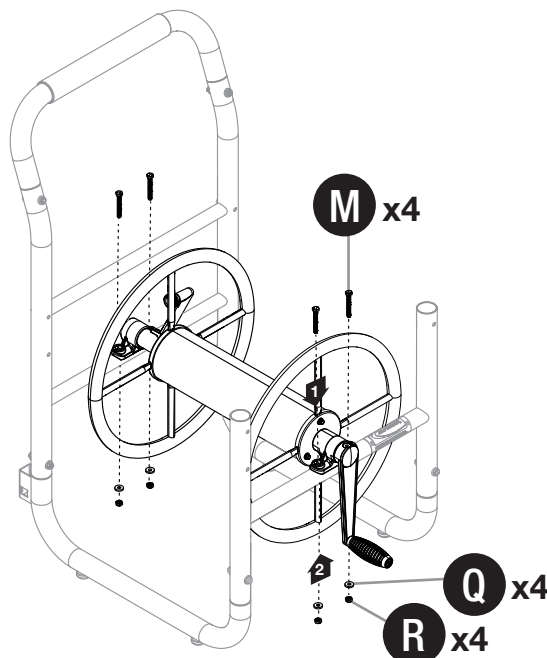

Remove hardware from Reel Bracket, both sides. Attach reel assembly to cart using four bolts (M), four washers (Q) and four nuts (R). This is the same hardware previously removed in step 9.

11

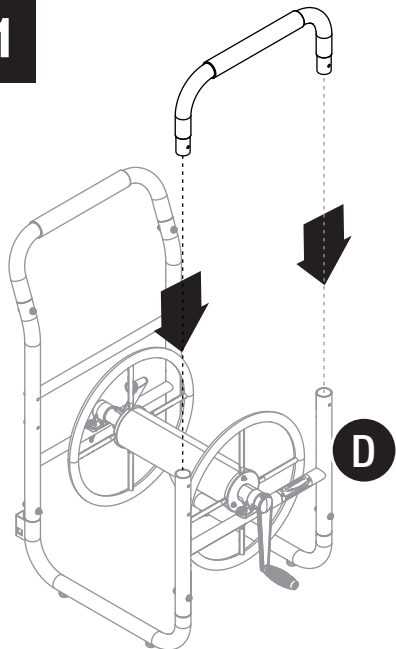

12

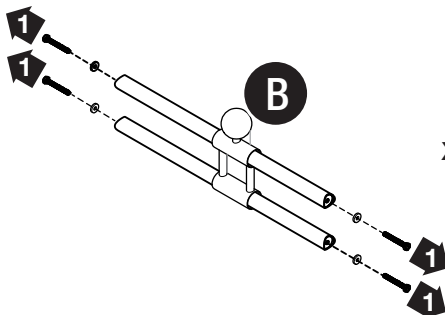

13

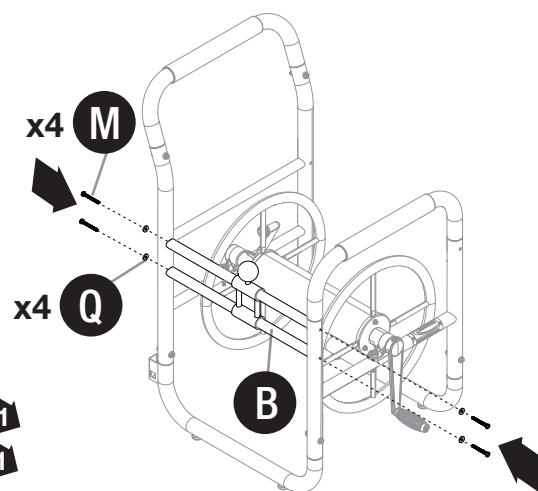

Lower Front Handle, from step 8, and insert into (D). Remove hardware from tracker assembly (B). Attach (B) to cart using four bolts (M), and four washers (Q).

14

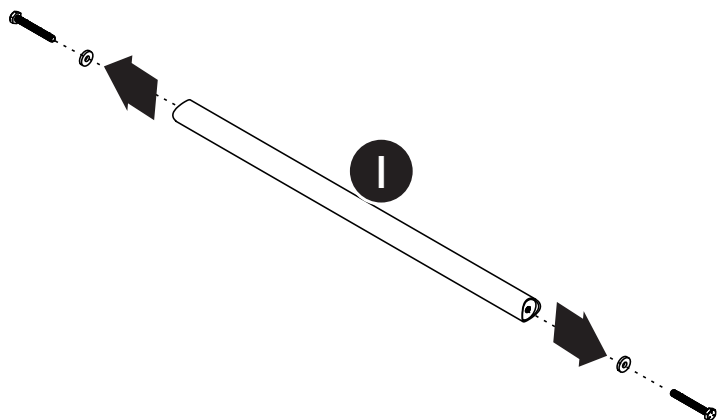

15

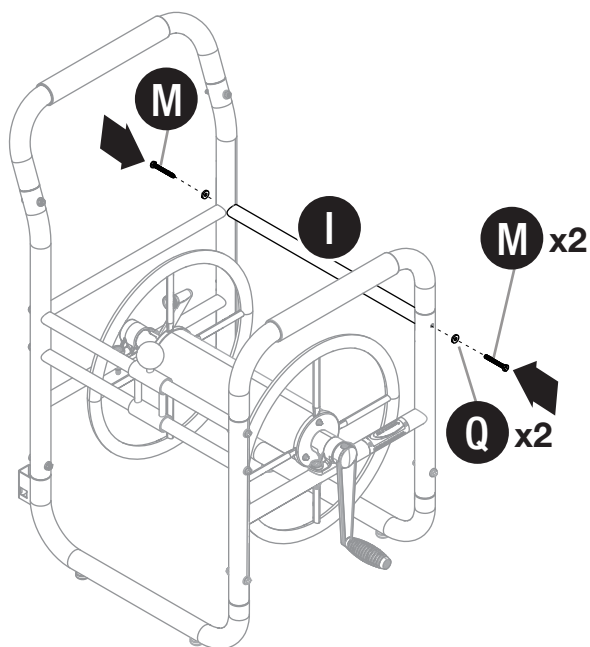

Remove screws from side bar (I). Attach side bar (I) to cart using two bolts (M) and two washers (Q).

16

17

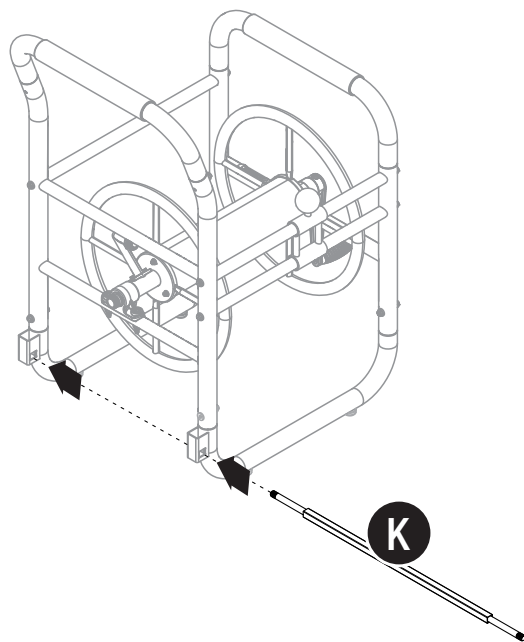
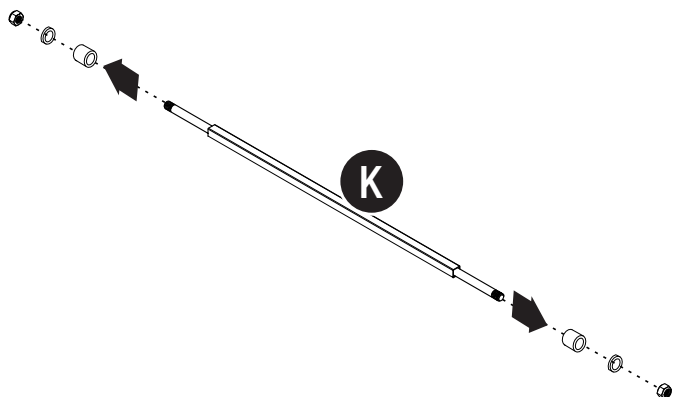

Remove all hardware from axle (K). This hardware will be used in step 19. Insert axle (K) into holes on lower rear of cart.

18

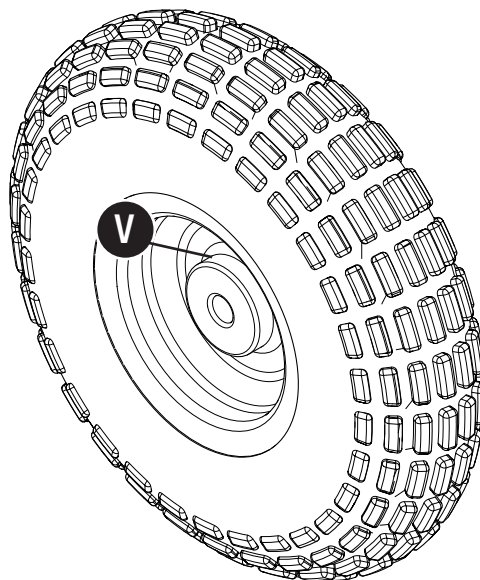
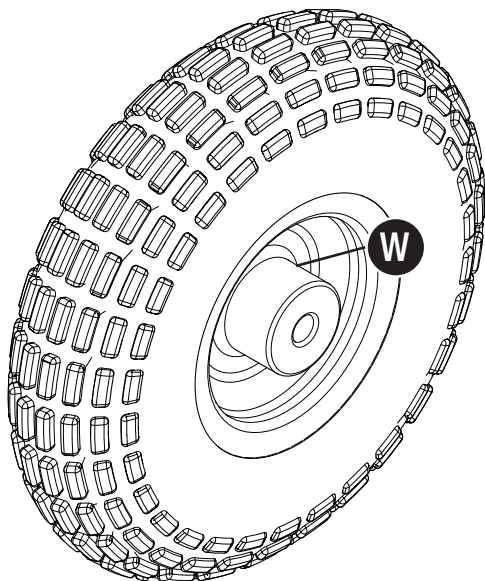

Longer section of hub (W) must always face inward toward hose reel. Shorter section of hub (V) should always face outward when placed on axle.

19

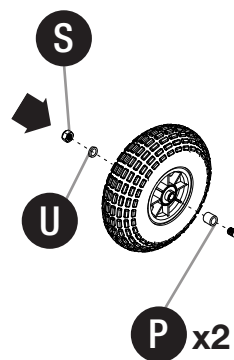

See note on previous step regarding wheel orientation

20

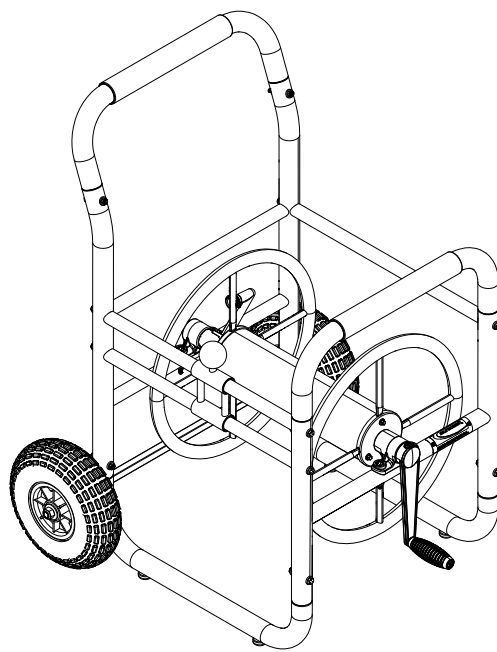
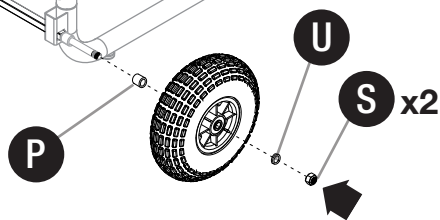

Insert one sleeve (P) on each side of the axle. Place each wheel onto axle. Place rubber washer (U) on outside of each wheel and finish by threading nut (S) onto the axle on each side and tightening. **DO NOT** over-tighten axle nuts. Wheels should spin freely, without excessive wobble. Your hose reel is complete.

21

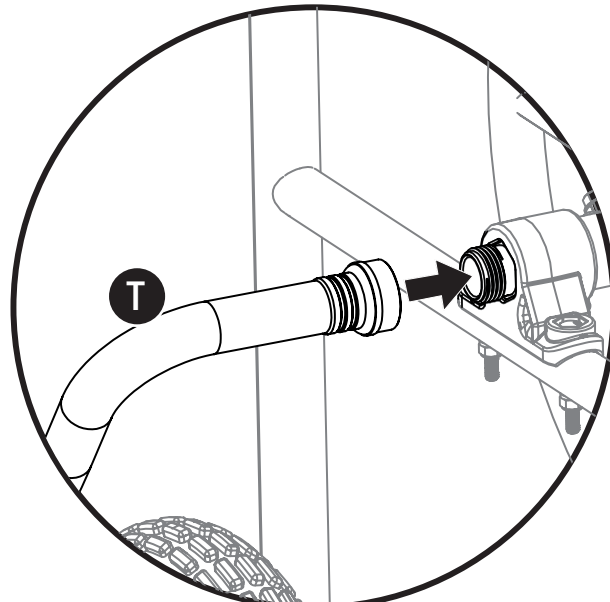
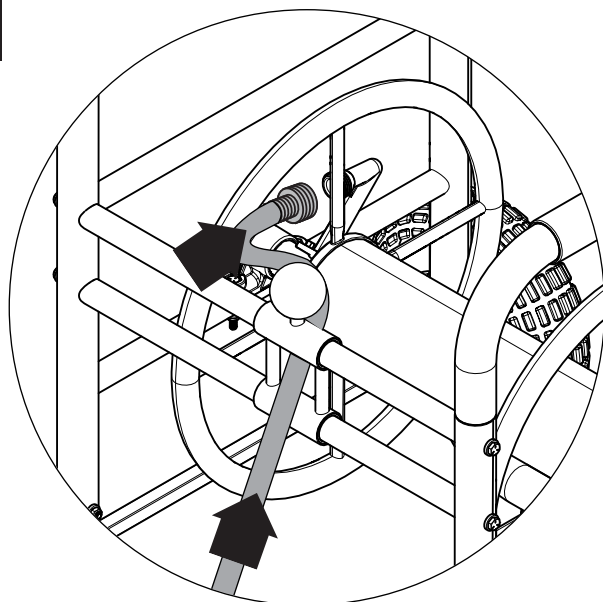

Insert garden hose through tracker and back flange and connect to out tube. Install up to a 200 ft. heavy duty 3/4" hose.

NOTE: Place foot on C to stabilize cart while winding garden hose.

Warranty

SUNCAST® Hose Reel with Metal Water Connection System Three Year Limited Warranty

Your SUNCAST® Hose Reel with a METAL WATER CONNECTION SYSTEM has a THREE YEAR LIMITED WARRANTY against leaks and product failure resulting from defects in manufacturing or materials. The warranty period starts on the delivery date.

Warranty Claims

To file a warranty claim contact the manufacturer, SUNCAST® CORPORATION, 701 North Kirk Road, Batavia, Illinois, 60510. Call toll free (800) 846-2345 or visit www.Suncast.com.

SUNCAST® will repair or replace only the parts that failed under the terms of the warranty. In some cases, the replacement parts may not be identical, but they shall be of equal or greater performance than the original part.

We may require proof of purchase. Proof of purchase may be the original dated store receipt. We may require evidence of the failure. Evidence of failure may include photographs or returning failed components to SUNCAST.®

WARRANTY LIMITATIONS

THIS WARRANTY COVERS ONLY DEFECTS THAT AFFECT THE FORM, FIT OR FUNCTION OF THE UNIT. It excludes natural aging of the unit, discoloration, ordinary wear and tear, ordinary weathering, sunlight fading, or rust. It excludes staining caused by mold, mildew or tree sap and damage caused by animals including insects, vermin or household pets. The warranty does not cover damage caused by Acts of Nature including but not limited to: wind in excess of 65 mph; tornado; hurricane; microburst; hail; flood; blizzard; extreme heat; pollution or fire events. The warranty does not cover damage caused by Sun energy reflected from "Low-E" windows or other reflective materials. The user is responsible for protecting the product from damage in this situation.

The following actions void the warranty: improper assembly; assembly on a foundation other than as described in the assembly instructions; use above intended and reasonable capacity; misuse; abuse; failure to perform ordinary maintenance; modification; cleaning with abrasive tools, exposing the unit to heat sources and vandalism. Painting, sandblasting, cleaning with harsh chemicals not recommended for plastics voids the warranty on resin components. Modification of the original product voids all warranties. Suncast assumes no liability for any modified product or consequences resulting from failure of a modified product. Disassembly of this unit for reasons other than authorized repair voids the warranty. This warranty does not cover damage to the unit caused by improper hose attachment or defects caused by the consumer's hose or hose attachments.

Suncast® is not responsible for: loss of use of the unit; labor for repair; inspection fees or disposal costs.

THIS WARRANTY IS NONTRANSFERABLE. IT IS VALID FOR NORMAL HOUSEHOLD USE ONLY. THE WARRANTY IS VOIDED BY COMMERCIAL OR INDUSTRIAL USE. IT EXCLUDES FLOOR MODELS, CLEARANCE AND OPEN BOX UNITS.

Notice

Suncast® does not represent that this unit will meet city, county, state, homeowner's association standards or zoning requirements. The owner is responsible for securing all permits and meeting other requirements needed for placement, construction and use.

THE MANUFACTURER'S LIABILITY HEREUNDER IS LIMITED SOLELY TO THE REPAIR OR REPLACEMENT OF THE DEFECTIVE PRODUCT OR PART AND THE MANUFACTURER SHALL IN NO EVENT BE LIABLE FOR ANY INCIDENTAL OR CONSEQUENTIAL DAMAGES WHICH MAY RESULT FROM ANY DEFECT IN MATERIAL OR WORKMANSHIP OR FROM THE BREACH OF ANY EXPRESS OR IMPLIED WARRANTY.

This warranty gives you specific legal rights, and you may also have other rights which vary from state to state. Some states do not allow the exclusion or limitation of incidental or consequential damages; the limitation or exclusion may not apply to you.